

## POPPET CHECK VALVES

Poppet check valves allow the full flow of oil in one direction and block the flow in the opposite direction. Check valves may also be used as a directional or pressure control in a hydraulic system. Incorporating a check valve near the pump outlet will provide necessary pump protection from backflow and back pressure.

### DIMENSIONS

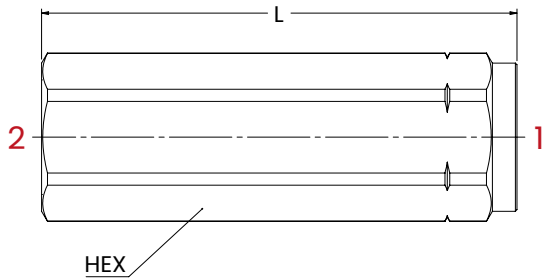

Bailey Part No.	Model Code	Port Size	Max Pressure psi	Flow gpm	Dimensions		Weight lb
					L in	Hex mm	
<b>7 psi Cracking Pressure</b>							
280400	CV-04N	1/4 NPT	5,800	8	2.28	19	0.22
280402	CV-06N	3/8 NPT	5,800	12	2.71	22	0.40
280404	CV-08N	1/2 NPT	5,800	18.5	2.95	27	0.50
280406	CV-12N	3/4 NPT	5,800	29	3.48	35	1.00
280408	CV-16N	1 NPT	5,075	42	4.33	41	0.73
280410	CV-06S	SAE-06	5,800	8	2.71	22	0.19
280411	CV-08S	SAE-08	5,800	13	2.95	27	0.39
280412	CV-12S	SAE-12	5,800	24	3.48	35	1.00
<b>65 psi Cracking Pressure</b>							
280401	CV-04N-65	1/4 NPT	5,800	8	2.28	19	0.22
280403	CV-06N-65	3/8 NPT	5,800	12	2.71	22	0.40
280405	CV-08N-65	1/2 NPT	5,800	18.5	2.95	27	0.50
280407	CV-12N-65	3/4 NPT	5,800	29	3.48	35	1.00
280409	CV-16N-65	1 NPT	5,075	42	4.33	41	0.73

**Material:** Zinc plated steel body

**Recommended working conditions:**

- Filtration: 15 microns or better
- Ambient temperature: -4° to 122°F (-20° to 50°C)
- Oil Viscosity: 15° to 250 cSt
- Oil Temperature: -4° to 176°F (-20° to 80°C)